

Akustik + Sylomer®

GRAN AKUSTIK + SYLOMER®

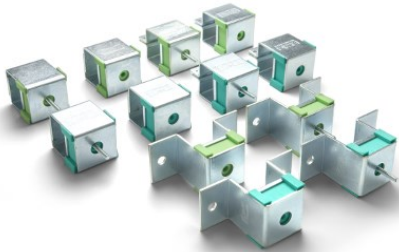

These antivibration mounts have been conceived for suspension from suspended ceilings, vibrating pipelines and machinery that has to be suspended. The excellent properties of the Sylomer® microcelular polyurethane achieve elevated isolation values as opposed to other mounts using rubber or cork, or a combination of both.

TECHNICAL CHARACTERISTICS

These antivibration mounts are manufactured in two special mixes of Sylomer® to adapt better to the load of each application. A great variety of fixing windows and elements facilitate installation and adapt better to each type of job.

Their rugged metal parts can withstand tensile stresses from 650 to 1000 Kg. They are supplied with an anticorrosive treatment that can withstand the toughest environments.



Akustik + Sylomer®

GRAN AKUSTIK + SYLOMER®

DRAWINGS

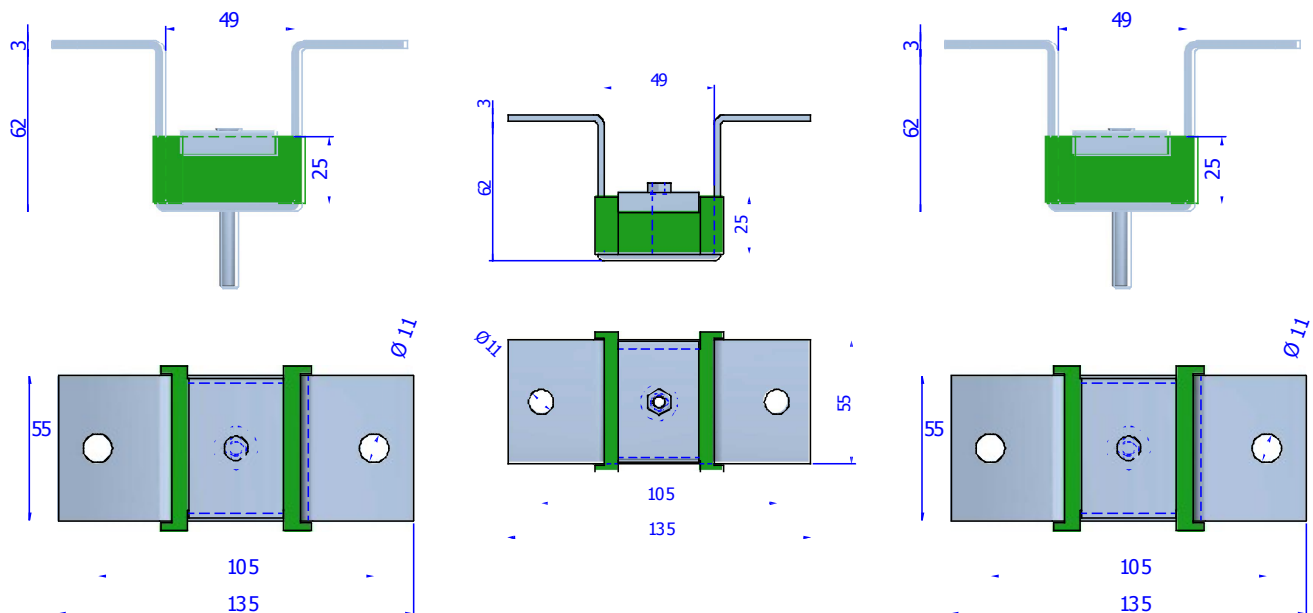

DIMENSIONS

	Type	SUMMARY	LOAD Kg. MAX	Code
	Gran Akustik 1 + Sylomer®60 Type A	It is secured directly to the ceiling by means of two holes and to the profile by means of a "type A" screw.	60	23601
	Gran Akustik 1 + Sylomer®60 Type B	It is secured to the ceiling with two holes and to the profile by means of a "type B" female fixing.	60	23609
	Gran Akustik 1 + Sylomer®150 Type A	It is secured directly to the ceiling with two holes and to the profile by means of a "type A" male screw.	150	23617

Akustik + Sylomer®

GRAN AKUSTIK + SYLOMER®

Akustik + Sylomer®

GRAN AKUSTIK + SYLOMER®



Akustik + Sylomer®

GRAN AKUSTIK + SYLOMER®

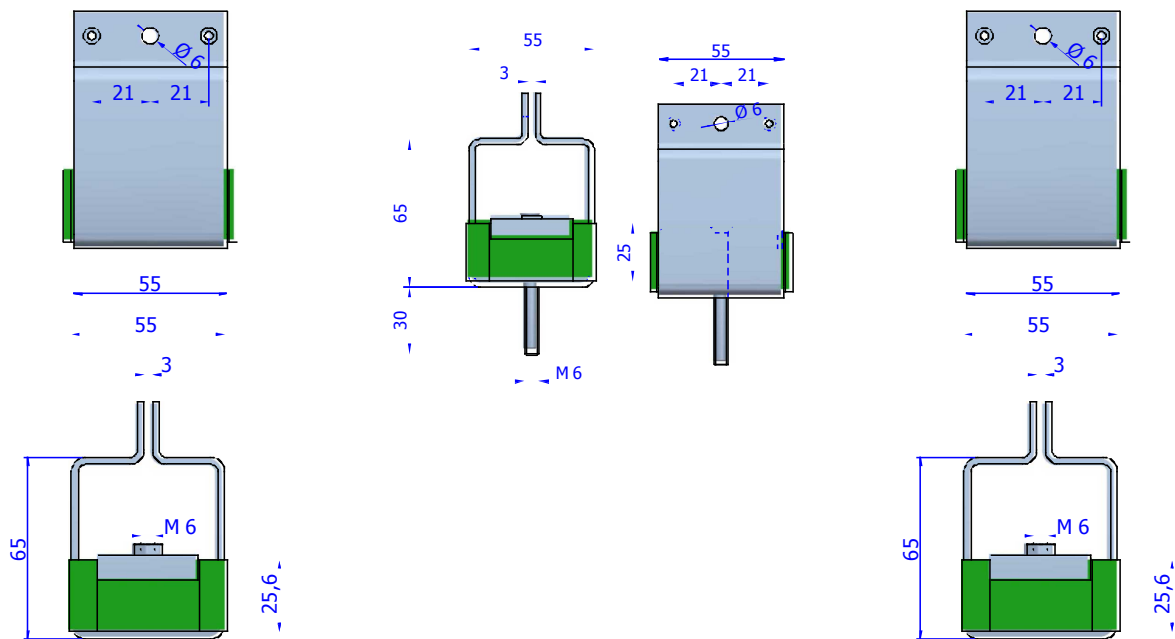
DRAWINGS



DIMENSIONS

	Type	SUMMARY	LOAD Kg. MAX	Code
	Gran Akustik 3 + Sylomer®60 Type B	It is secured directly to the ceiling by means of a "Type B" female fixing and to the "inverted double T" type profile thanks to the design of its metal armor.	60	23615
	Gran Akustik3 + Sylomer®150 Type A	It is secured directly to the ceiling by means of one screw and to the "inverted double T" type profile thanks to the design of its metal armor.	150	23623
	Gran Akustik 3 + Sylomer®150 Type B	It is secured directly to the ceiling by means of one "type B" female screw and to the "inverted double T" type profile thanks to the design of its metal armor.	150	23631